

RE385LN (5 POLE) NOISE ATTENUATED DC MOTOR

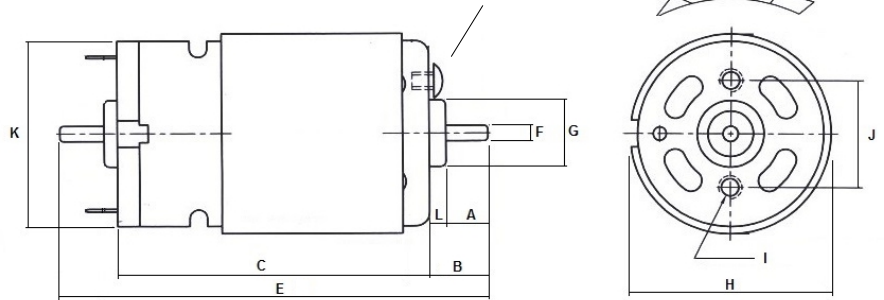

Part No: 457RE385LN (MOTOR WITH BRACKET)
 Part No: 719RE385LN (MOTOR WITHOUT BRACKET)
 Part No: 725 MOTOR BRACKET (90° ONLY)

Restriction of screw length:
 2.5mm MAX (From Motor Mounting Face)



Weight: 110g (approx)

DIMENSIONS	A	B	C	E	F	G	H	I	J	K	L
Millimeter	6.3	8.8	46.6	64.0	2.3	10.0	30.0	M2.6	16.0	27.5	2.5

MOTOR DATA. (RE385LN)

MODEL	VOLTAGE		NO LOAD		AT MAXIMUM EFFICIENCY					STALL TORQUE		
	OPERATING RANGE	NOMINAL	SPEED	CURRENT	SPEED	CURRENT	TORQUE		OUTPUT	EFF	TORQUE	
			R.P.M.	A	R.P.M.	A	oz-in	g-cm	W	%	oz-in	g-cm
RE385LN	6 - 12	12v Constant	7200	0.19	5950	0.9		110	6.72	62		660

Stall Current: RE385LN at 12v = 5.0A